

Contact ResLife



Email us
reslife@oswego.edu



Ask us
315.312.2246



Like us
facebook.com/ResLifeOswego



Follow us
twitter.com/OswegoResLife



Watch us
youtube.com/SunyOswegoVideo



Follow us
ResLifeOswego

Did You Know...

- Residence Life operates 13 residence halls and 68 townhouse units on campus.
- Residence Life and Housing employs approximately 375 students as: Resident Assistants/ Resident Mentors(RA/RMs), Desk Attendants (DAs), Recycling Technicians, Computer Technicians, and Fitness Center Attendants.
- In the fall of 2017, SUNY Oswego housed 4,333 students.
- Residents can participate in hundreds of hall programs plus weekly floor activities.

2018-2019

Live SUNY OSWEGO residence life AND HOUSING where you **Learn**

www.oswego.edu/reslife

New Student Guide to Living on Campus



The State University
of New York





Questions?

If you have any questions that are not answered in this booklet, check out our website at

www.oswego.edu/reslife

Feel free to call Residence Life and Housing at (315) 312-2246, Monday through Friday, 8:00 a.m. - 4:00 p.m.

Questions can also be emailed to reslife@oswego.edu or posted on our Facebook page. Follow us on twitter and Instagram to learn more about on-campus living!

We look forward to seeing you soon!

315.312.2246



reslife@oswego.edu

resLifeOswego



[oswegoResLife](https://twitter.com/oswegoResLife)

resLifeOswego



[sunyOswegoVideo](https://www.youtube.com/sunyOswegoVideo)



Our Mission

Residence Life and Housing provides secure, welcoming and engaging living environments that encourage and support the academic and personal success of residential students.



Contents

3

**DIRECTOR'S
MESSAGE**

4

**WHO
LIVES
ON
CAMPUS?**

5

**ROOM
ASSIGNMENTS**

6

YOUR ROOM

- 6 Internet and WiFi
- 6 What telephone service is available?
- 6 What television service is available?
- 7 What should I bring?
- 7 What else might I want to bring?
- 8 What if I bring something that is prohibited?
- 8 How much electric/electronic equipment can one room handle?
- 9 Should I insure my belongings?
- 9 How do I create more space in my room?
- 10 What size are the rooms?
 - West Campus Halls
Onondaga
- 11 Cayuga, Oneida, Seneca
- 12 • Lakeside Halls
Johnson, Riggs, Scales, Waterbury
- Central Campus Halls
Hart, Funnelle
- 13 • East Campus Halls
Lonis, Moreland, Sheldon
- 14 • Student Lounges as Bedrooms
Cayuga, Oneida, Seneca

15

SERVICES

- 15 Front Desk
 - Mail
- 16 • Residence Hall
Street Address
 - Packages
- 16 Laundry
- 16 Storage
- 17 Early shipment
of belongings
- 17 Recycling
- 17 Computer Labs
- 17 Security

17

THE DEPARTMENT OF RESIDENCE LIFE AND HOUSING

- 17 Residence Hall Staff
- 18 Departmental Staff
- 19 Fitness Center

20

POLICIES

- 20 Alcohol
- 20 Appliances
- 20 Drugs
- 20 Fire Safety
- 21 Guests
- 21 Noise
- 21 Pets
- 21 Smoking
- 21 Solicitation
- 21 Visitation and Guests

22

FURTHER QUESTIONS?

Your Future
Housing
Assignment

23

**CAMPUS
MAP**

24

RESIDENCE HALL OPENING & CLOSING SCHEDULE

Fall Semester
2018 and
Spring Semester
2019

Welcome to life on campus...

Congratulations!

on your decision to attend SUNY Oswego. The Oswego campus is an excellent environment for learning, and living on campus only enhances your overall learning experience. Students living in residence have the opportunity for informal learning through contact with faculty, staff, and peers. The residential experience provides students with ready access to the intellectual and social events and organizations that are a vital part of the liberal arts college environment.

The experience of living on campus assists students in making a more successful and productive transition to college. Furthermore, living in residence halls helps students attain their academic and personal goals through our Student Learning and Success program. The 'SLAS' program promotes the holistic growth and development of all students through programs that teach acceptance, respect, responsibility, altruism, ethics, and leadership. It also facilitates an environment in which students value diversity of ethnicity, thought, culture, and lifestyle. We expressly encourage student participation in service to the campus and community at large.

We invite you to become an engaged member of the SUNY Oswego learning community. By living on campus you will share in the excitement of intellectual exploration in and out of the classroom, meaningful and lasting personal growth, and the sharing of ideas, concepts and culture. The relationships you build and the human relations skills you learn will help you socialize and work with others. In your interactions with other students you will have the opportunity to explore your own values.

We are delighted that you will be attending SUNY Oswego and living on campus. Going to college is a huge step in your educational and personal development. We are excited and anxiously await your arrival this fall.

Sincerely,



Richard R. Kolenda, Ed. D.
Assistant Vice President for Residence Life and Housing

WHO LIVES ON CAMPUS?

The College believes that immersion in the educational environment is the preferred experience for new students. Therefore, all full-time undergraduate students who will need to establish an Oswego-area residence in order to attend the College are required to live on campus to the extent that facilities are available and utilized*.

Students generally exempted from this requirement are those who:

- will continue to reside with their parent(s) or legal guardian(s);
- will continue to reside in their official residence, which is separate from that of their parent(s) or legal guardian(s), and at which they had resided for at least three consecutive months prior to their acceptance of the admissions offer from the College;
- are married; or
- are twenty-one (21) years of age as of September 1 for fall admission or January 1 for spring admission.

Students in these categories must submit a *Request for Exemption* form available on the Department's web site and at 303 Culkin Hall.

*Due to current facility availability, students who fulfill specific criteria will be considered as having fulfilled the Housing Requirement and would no longer be required to live in College Housing; these students are those who first enrolled at SUNY Oswego as:

- first year students and have lived in residence at SUNY Oswego for four (4) consecutive semesters (fall and spring) if admitted in the fall or three (3) semesters if admitted in the spring.

-OR-

- transfer students and have lived in residence at SUNY Oswego for two (2) consecutive semesters (fall and spring) if admitted in the Fall or one (1) semester if admitted in the Spring.



ROOM ASSIGNMENTS

At this point, you should have logged into **myHousing.oswego.edu** to accept the terms of the Room and Board Agreement and submit Housing Preferences (such as roommate requests and preferences for specific residence halls). After the majority of new student room assignments are made (late June), you can access the info at **myHousing**; you'll be able to see your actual room assignment and the name and contact information for your roommate! We encourage you to contact your

roommate(s) to become acquainted and start planning what each of you will be bringing for your room. Although entering students (first year, transfer and readmitted) are given no guarantee of assignment to a specific building or room, every attempt is made to honor students' preferences.

The Department of Residence Life and Housing will attempt to honor roommate requests when all students involved have requested each other (electronically or in writing) before any of the involved students have been assigned to a room.

The College will assign roommates for students who do not express roommate preferences. In general, entering students are assigned rooms in accordance with the date on which the College receives their room deposit payment. **The College does not discriminate on the basis of race, religion, national origin, gender identity or sexual orientation in these assignments.**

A note about room assignments:

If you have not received your room assignment by August 15th or have questions, please contact the Residence Life and Housing Office at reslife@oswego.edu or call (315) 312-2246, Monday through Friday between 8:00 a.m. and 4:00 p.m.



YOUR ROOM

Residence hall rooms are typically furnished with a bed, dresser, desk, desk chair, and closet for each resident. Room furnishings also include a floor lamp, wastebaskets, one mirror, and blinds. While this setup is standard, by the start of classes each room will begin to develop its own "look." Coordinating the furnishings and arrangements for your room is a good opportunity to become better acquainted with your new roommate(s). Some things you may want to discuss are:

- sharing belongings
- social and academic expectations and desires
- study and sleep habits
- who is bringing a TV (cable-ready), electronic equipment, etc.
- loft option, etc.

Internet and WiFi

All residential communities are part of the SUNY Oswego Wireless Network. In addition, all resident rooms have ResNet, Oswego's Residential Network, which provides a dedicated wired connection to the campus network. One data connection is provided to each resident. If you have further questions, please contact the CTS Help Desk at help@oswego.edu.

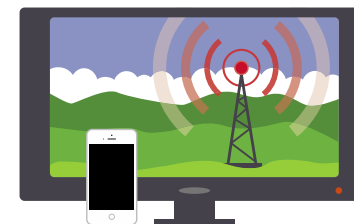

What telephone service is available?

The College no longer provides active phone lines in individual residence hall rooms. If you would like phone access in your room, contact the Campus Technology Services (CTS) Help Desk at help@oswego.edu. By default, this phone service provides on-campus service only. If you would like to place off-campus calls, you will also need to arrange for long distance services.

What television service is available on campus?

Each residence hall has at least one television lounge with cable service and a large-screen TV. Student (bed)rooms are also equipped with cable TV service, but students must provide their own TV. SUNY Oswego recently upgraded the channel line-up received from our service provider, Spectrum. Most channels are high definition digital, and the service does not require a set-top box cable receiver; however, your TV must be

equipped with a QAM (quadrature amplitude modulation) tuner. Most TVs purchased after 2010 have QAM tuners but refer to your TV's specifications to be sure. The complete channel line-up and more information can be found at <https://www.oswego.edu/cts/cable-tv-setup>.

What should I bring?

• Clothing



It is not necessary to bring your entire wardrobe when you first move in! Given that dresser and closet space are limited, consider College recesses as opportunities to change your seasonal wardrobes. The first time the halls close during the fall semester is for Thanksgiving break.

Average monthly temperatures in Oswego are:

September.....mid 60°s	Marchmid 30°s
October.....low 50°s	Aprilmid 40°s
November.....low 40°s	Maymid 50°s
December.....low 30°s	Junemid 60°s
January.....mid 20°s	Julylow 70°s
February.....mid 20°s	August70°s

• Bed and bath linen

You will need to bring your own pillow, pillowcases, mattress pad, sheets, blankets, bedspread, towels and washcloths. All SUNY Oswego regular residence hall mattresses are 80 inches long, 6.5 inches deep and 36 inches wide; they require “extra long” twin sheets.

What else might I want to bring?

While shopping, please use the SUNY Oswego approved checklist found at: www.oswego.edu/reslife/what-bring

NOTE! Lists provided at stores may include items that are **prohibited** in our residence halls. The items below are a sample from our approved list:

- | | |
|--------------------------------------|--|
| <input type="checkbox"/> Alarm clock | <input type="checkbox"/> Camera |
| <input type="checkbox"/> Area rug | <input type="checkbox"/> Clothes hangers |
| <input type="checkbox"/> Boot tray | <input type="checkbox"/> Coffee maker/Keurig |

list continued...

- | | |
|---|---|
| <input type="checkbox"/> Compact refrigerator* | <input type="checkbox"/> Laundry supplies & iron |
| <input type="checkbox"/> Computer | <input type="checkbox"/> Approved power strip (see below) |
| <input type="checkbox"/> Crates/storage bins | <input type="checkbox"/> Recreational equipment |
| <input type="checkbox"/> Dishware/utensils | <input type="checkbox"/> Stamps |
| <input type="checkbox"/> Electronic equipment | <input type="checkbox"/> Towels (hand & shower) |
| <input type="checkbox"/> Headphones | <input type="checkbox"/> TV coaxial cable |
| <input type="checkbox"/> Hot pot or electric kettle with automatic shut-off | |

*Compact refrigerators must not exceed 6 cubic feet and operate on no more than 2.0 amps. Residence Life & Housing has refrigerators for rent. Visit our website at:

www.oswego.edu/reslife/forms

What if I bring something that's prohibited?

The following items are prohibited. If found in the residence halls, they will be confiscated and disciplinary action may be taken.

- | | |
|--|--|
| • air conditioners | • incense |
| • candles | • microwave oven |
| • cinder blocks | • toaster/toaster oven |
| • extension cords | • wax burners |
| • hoverboards | • other cooking appliances, such as: sandwich makers, grilling machines, hotplates, slow cookers, crock pots, rice cookers |
| • oil burning, halogen, lava, torchiere/tree-style and multi-head or “octopus-style” lamps | |

Confiscated items will not be returned!



Please note!
The list of prohibited lamps above and examples are for reference only and are not intended to show every possible lamp that is prohibited.

How much electric/electronic equipment can one room handle?



Keep in mind that overloading of electrical circuits is a common cause of electrical fires. In order to ensure a safe environment, **the use of electrical extension cords is strictly PROHIBITED in residence halls and academic buildings on campus.** However, circuit-breaker-protected multi-outlet power strips that are UL-approved can be used. “Daisy chaining” (connecting one or more of these power strips to each other) is not permitted.

Should I insure my belongings? Yes, definitely!

The College assumes no responsibility for loss, theft or damage to personal property, even if that loss was caused by the failure of a College mechanical system such as a pipe bursting. We strongly encourage you to have insurance coverage before you begin residency. Typically, such coverage may be provided by extension of a homeowner's policy, renter's insurance or insurance specifically for college students. Many vendors offer low cost insurance specifically directed to the college environment. Two such vendors are: College Student Personal Property Insurance (www.nssi.com) and CSI (www.CollegeStudentInsurance.com).

How do I create more space in my room?

The standard or 'default' bed setup allows for 28 inches of storage space below the bed (see below). However, our residence hall beds can be positioned at several different heights, creating more storage space and/or greater flexibility for room configuration. To request a bed setup other than the default when you move in, submit your *Loft Request* online by July 27, 2018. To do so, log in to myHousing.Oswego.edu; then, click 'Applications' at the top of the page. Choose 'Loft Request New Student' from the dropdown menu and follow the prompts.

More info about bed options at www.oswego.edu/reslife/forms



What size are the rooms?

Although the actual dimensions of rooms vary from building to building, the average square footage is 185. In order to plan for the set up of your room, we have provided diagrams and measurements of rooms in each residence hall below.

• West Campus Halls

Onondaga Hall*

- 600 Residents
- 10 Floors - Suites (Upper-class students only)
- Window Frame = 51.25" x 63.75" (1st floor)
- Window Frame = 51" x 58" (2nd through 10th floors)
- Ceiling Height = 8'
- Closets
 - width = 41"
 - depth = 21"

*Onondaga is our "suite style" residence hall. There are primarily 3-room suites and a few 2-room suites in the building. Suites are unique in that they have a private bathroom and common living area that only the suitemates share.

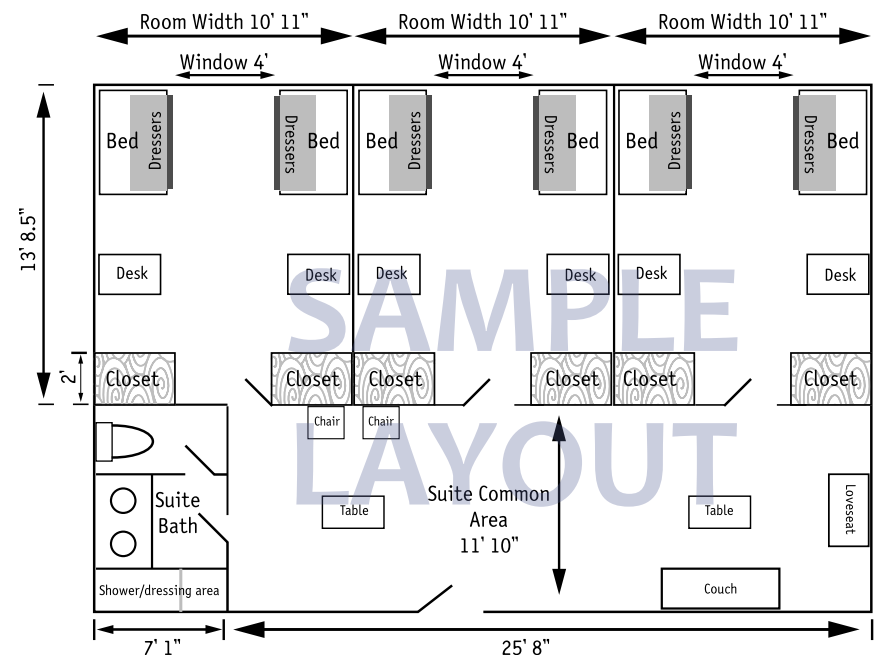

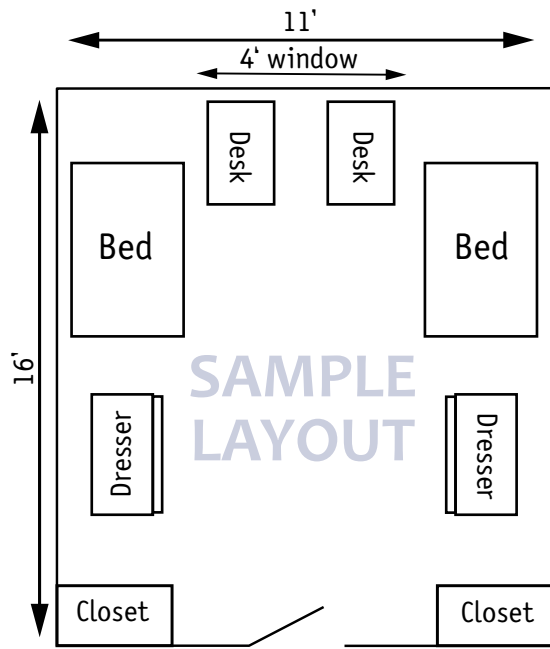

• **West Campus Halls**
(continued)

Cayuga Hall

- 400-500 Residents
- 4 Floors
- Window Height = 64"
- Ceiling Height = 8'
- Closets
width = 43"
depth = 23.5"

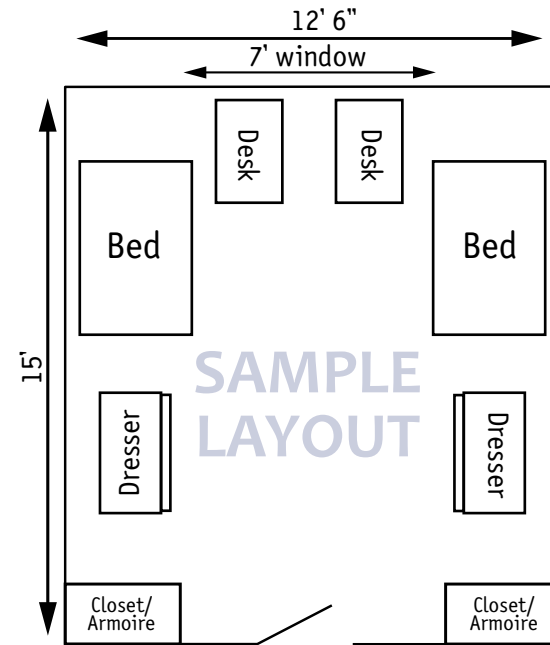

• **Lakeside Halls**

Johnson, Riggs, Scales and Waterbury Halls

- 200 Residents per hall
- 4 Floors
- Window Height = 53.5"
- Ceiling Height = 8'
- Armoire with mirror
width = 42-48"
depth = 2'
height = 84-86"

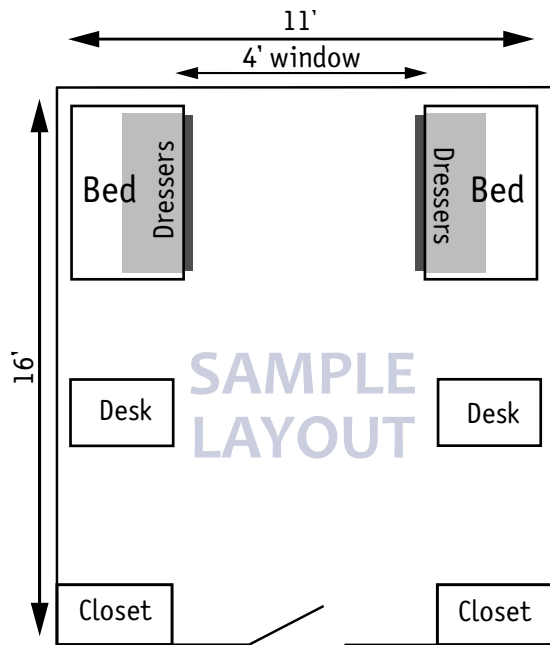

Oneida Hall

- 400-500 Residents
- 4 Floors
- Window Height = 56"
- Ceiling Height = 8'
- Closet
width = 43"
depth = 23.5"

Seneca Hall

- 600 Residents
- 10 Floors
- Window Height = 64"
- Ceiling Height = 8'
- Closet
width = 43"
depth = 23.5"

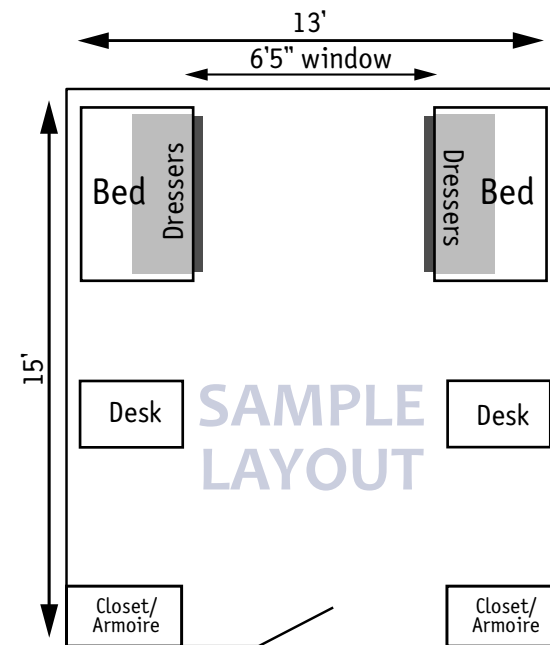

• **Central Campus Halls**

Hart Hall

- 336 Residents
- 9 Floors
- Window Height = 52.5"
- Ceiling Height = 8'
- Armoire with mirror
width = 44-48"
depth = 2'
height = 84"

Funnelle Hall

- 400 Residents
- 9 Floors
- Window Height = 53"
- Ceiling Height = 8'
- Closets
width = 52"
depth = 26"

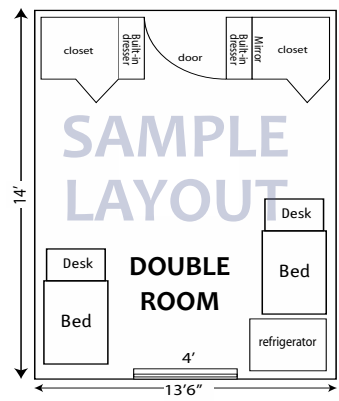

- **East Campus**
- **Lonis Hall**
- **Moreland Hall**
- 75-150 Residents per hall
- 3 Floors
- Window Height = 53.5"
- Ceiling Height = 8'
- Closets
width = 34-36"
depth = 23-24"

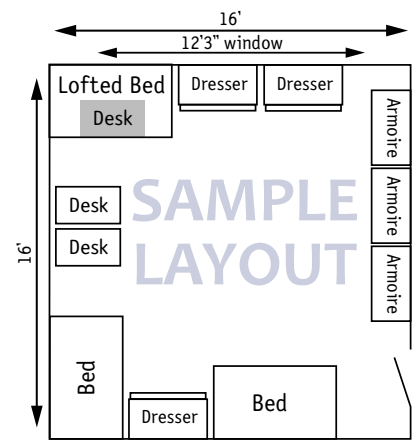

- **Student Lounges as Bedrooms "S-rooms"**
- **Cayuga Hall Lounge**
- 3 Residents each
- Window Height = 42.5"
- Ceiling Height = 8'
- Armoire with mirror
width = 44-48"
depth = 2'
height = 84"

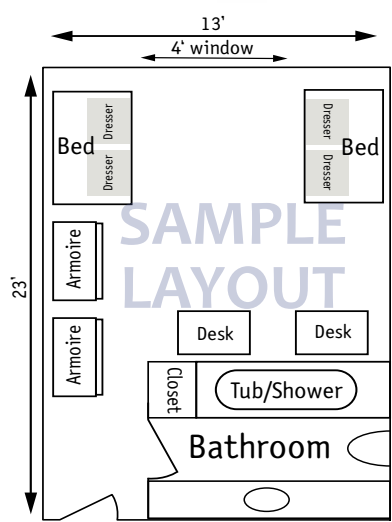

- **Sheldon Hall**
- 70 Residents
- 2nd and 3rd Floors of the east wing
- **Typical Double Room**
- Ceiling Height = 12'
- Closet
width = 31"
depth = 30"
height = 93"
- Armoire with mirror
width = 44-48"
depth = 2'
height = 84-86"

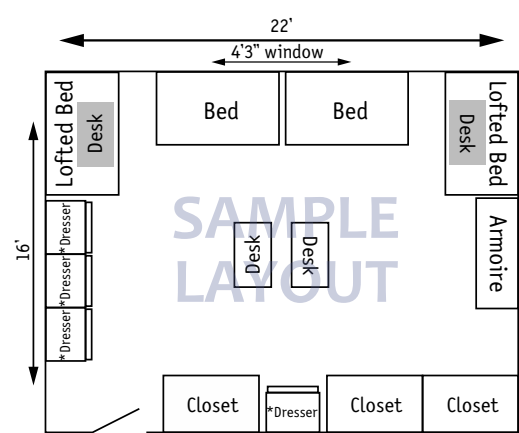

- **Oneida Hall Lounge**
- 4 Residents each
- Window Height = 56"
- Ceiling Height = 8'
- Closets
width = 3'-4'
depth = 2'
height = 88"
- Armoire with mirror
width = 44-48"
depth = 2'
height = 84"

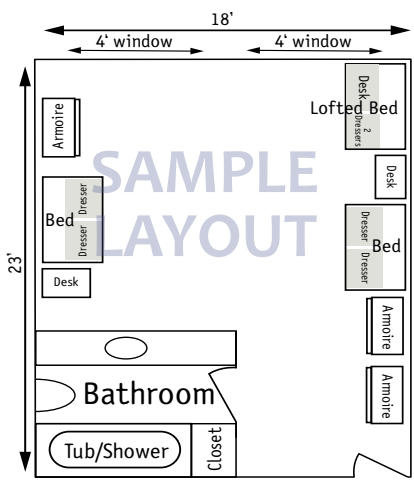

- **Typical Triple Room**
- Ceiling Height = 12'
- Closet
width = 69"
depth = 2'
height = 93"
- Armoire with mirror
width = 44-48"
depth = 2'
height = 84-86"

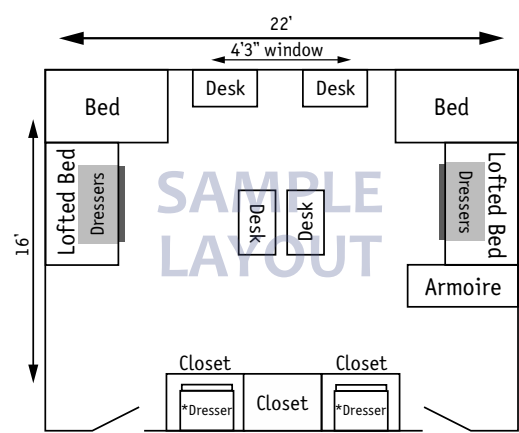

- **Seneca Hall Lounge**
- 4 Residents each
- Window Height = 58.5"
- Ceiling Height = 8'
- Closets
width = 44"
depth = 2'
height = 94"
- Armoire with mirror
width = 44-48"
depth = 2'
height = 84"

SERVICES

Front Desk

Each residence hall has a front desk, typically located in the main lobby. The desk is open from 10:00 a.m. to 3:00 a.m. seven days a week during the fall and spring academic semesters. Students are employed as Desk Attendants to provide information and services, such as the following: processing mail and packages; providing residents with temporary keys if they are locked out of their rooms; loaning of board games, sports equipment (i.e., pool cues, ping pong paddles), cooking supplies, vacuum cleaners, snow shovels, brooms, and dustpans.

All halls have DVD players and DVDs available for loan; some halls also have current video game systems available at the front desk. Each hall also has a microwave oven for resident use.

• Mail

Each resident is assigned a mailbox located near the front desk of each residence hall. Mail is received and sorted at the front desk Monday through Friday. Mail delivery will work most efficiently if mail is addressed as indicated below.

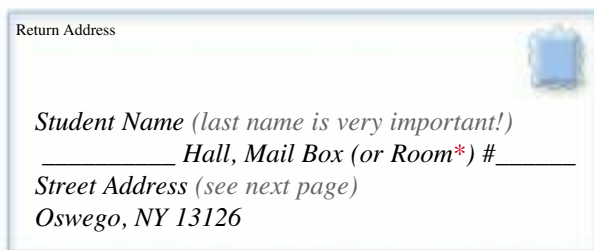

In most halls, each student has his or her own mailbox; in these halls (Cayuga, Hart, Johnson, Lonis, Moreland, Riggs, Scales, Sheldon, Waterbury and The Village), the mailbox number is different from the room number. To send mail to students in these halls, be sure to include the student's mailbox number in the address.

*In Funnelle, Oneida, Onondaga and Seneca Halls, roommates share a mailbox; in these halls, the mailbox numbers are the same as the room numbers. To send mail to students in these halls, please include the student's room number in the address.

Please note that the College cannot be responsible for cash or valuables sent through the mail.

• Residence Hall Street Addresses

The current 911 street addresses for each of the residence halls on campus is as follows:

- Cayuga Hall20 Cayuga Circle
- Funnelle Hall25 Union Road
- Hart Hall15 Union Road
- Johnson Hall20 Rudolph Road
- Mackin Complex
(Lonis Hall and Moreland Hall)53 Sheldon Avenue
- Oneida Hall10 Onondaga Circle
- Onondaga Hall20 Onondaga Circle
- Riggs Hall28 Rudolph Road
- Scales Hall34 Rudolph Road
- Seneca Hall47 Cayuga Circle
- Sheldon Hall72 Sheldon Avenue
- Waterbury Hall30 Rudolph Road

• Packages

Packages sent to residents are received at the front desk of each residence hall. If a package comes for you, you'll receive an email instructing you to pick up your package at the desk. You can ship packages via UPS and FedEx at The College Store's Shipping.

For more information, go to:

www.oswego.edu/college-store/shipping-storage

Shipping via US Postal Service is available at the Oswego Post Office.

Laundry

Each residence hall is equipped with laundry facilities. Cost for use is pre-paid as a fee on the student's College bill.

Storage

Luggage rooms are available in some residence halls to provide limited storage space for small items such as empty trunks and suitcases. Plan to put any items of value in your room where they will be most secure. Fire regulations prohibit storage of cardboard boxes in luggage rooms. In determining how much to bring to school, bear in mind that the College will not store student belongings over the summer; you will need to take all your belongings with you in May.

Early shipment of belongings

We do not accept shipments prior to our announced arrival date for residents. If you must make shipments to campus, please plan accordingly and include your full College address (see page 16).

Recycling

SUNY Oswego participates in the mandatory Oswego County recycling program. All students are required to routinely bring all recyclables and trash to a Recycling Room located in the basement of each residence hall.

Computer Labs and Rooms

Oneida Hall has a computer lab that is open to Oneida Hall residents and their guests. This in-hall facility allows ready access to computers, printers, and the campus network. Hart, Scales, and Waterbury Halls each have a computer room, which is available to hall residents only.

Security

In order to ensure reasonable security, there are policies and procedures in place to govern access to the buildings, locking and unlocking of building doors, and monitoring of visitors and guests. The specifics of these procedures (and all other policies and procedures) are listed in the **Resident Student Handbook**, available on-line.

THE DEPARTMENT OF RESIDENCE LIFE AND HOUSING

The Residence Life and Housing program at Oswego strives to provide students with a safe, well-maintained, and attractive living environment supportive of the educational mission of the College. Students living in residence have the opportunity for informal learning through contact with peers, staff, and faculty. The residential experience provides students with ready access to the intellectual and social events and organizations that are a vital part of the liberal arts college environment.

Residence Hall Staff

Each residence hall is staffed by a team of professional, student and custodial employees. Together with the residents and other College personnel, they work to provide the positive living experience at the core of our department's mission.

Each hall has a Residence Hall Director, a full-time professional who lives in the residence hall.

Buildings of 400 or more residents also have Assistant Hall Directors (graduate students who also live in the hall).

Each hall also has Resident Student Staff (RSS) who are RAs (Resident Assistants), RMs (Resident Mentors) or GRMs (Graduate Resident Mentors). These undergraduate and graduate students are employed and trained by the Department of Residence Life & Housing to provide a quality living and learning experience for residents. They live directly on the resident floors and serve as role models, helpers, counselors, administrators and mentors.

Furthermore, RSS enforce College policies to ensure that the health, safety and rights of all individuals are maintained. In addition, RMs (Johnson Hall) and GRMs (Hart Hall) have academic duties related to the special programs in their respective buildings. The front desks, recycling rooms, and computer labs (if applicable) are staffed by student employees. The Desk Attendants and Recycling Technicians (otherwise known as Student Operations Services Staff or "SOS") play a very important role in the functioning of the hall. Many halls will be hiring to fill vacancies in these positions in the fall.

Our residence halls are also staffed by custodians seven days per week throughout the fall and spring semesters. Together with Facilities, Maintenance and Operations staff, they ensure the cleaning and maintenance of our halls in compliance with a schedule of standards and routines. Copies of these standards are available at each residence hall front desk and the Residence Life and Housing Office, 303 Culkin Hall.

Departmental Staff

The staff who work directly in the residence halls are supported and supervised by the Department's Central Office Staff and the Management Team, which includes the Assistant Vice President for Residence Life and Housing, three Associate Directors, one Assistant Director, and three Community Development Specialists. Each of these professionals has served as a residential educator in college environments for many years. They are committed to student growth and development as well as



the training and enhancement of our professional and para-professional staff. We also have a Staff Assistant for Financial and Occupancy Operations.

Fitness Centers

Residence Life and Housing operates two on-campus fitness centers. Cooper Fitness Center is located between Hart and Funnelle Halls, and Glimmerglass Fitness Center is located between Oneida and Onondaga Halls. Under the direction of a full-time manager and two assistant managers, the centers are staffed by over 65 well-trained undergraduate students.

Both Fitness Centers are equipped with state of art free weights, Cybex circuits, cardiovascular equipment (including treadmills, elliptical trainers, etc.), and offer a wide variety of group exercise classes. Free Personal Training services are also available and Fitness Center staff plan and facilitate several fun special events and presentations throughout the academic year.

Non-resident membership costs vary according to the length of time a student lived on campus. The rates for resident students for the 2018-2019 academic year are:

- \$60 per semester
- \$110 per academic year

For more information, visit us at oswego.edu/fitness or use

#iamoswegofit



Cooper & Glimmerglass
fitness centers

POLICIES

Alcohol

The College permits individual consumption and possession of alcoholic beverages by individuals who have attained 21 years of age and prohibits consumption and possession by persons under 21. Open containers of alcohol are prohibited in public areas of the residence halls. Refer to the alcohol and drug section of the *Student Handbook* for the complete policy description.

Appliances

All electrical appliances must be UL-approved and must be in good working order. Prohibited appliances are included in the list of prohibited items earlier in this publication (see page 8). Any prohibited appliance found in the residence hall will be confiscated by Residence Life and Housing staff and will not be returned to its owner. Additional prohibited items are listed in the *Resident Student Handbook*.

Drugs

The use, possession, distribution or manufacture of controlled substances is prohibited on College premises. The possession and/or use of small amounts of marijuana in one's room is a violation of New York State law, and any consumption of marijuana in a public area is a criminal offense. Drugs or drug-related paraphernalia can be confiscated and used as evidence.

Fire Safety

All individuals are required to evacuate the building upon activation of the fire alarm system. Theft or improper use of fire fighting, detection, and/or alarm equipment is prohibited. Setting fire is prohibited with the exception of designated fireplaces. Possession and/or ignition of combustible materials (including, but not limited to, candles, incense and wax warmers) and suspending combustible materials (such as tapestries, curtains, flags, fishnets, etc.) are also prohibited. Additional furniture, decorations and other items that increase the flammability of living units or public areas may be prohibited at the discretion of Residence Life and Housing staff. Examples of prohibited items include: hoverboards; halogen, lava, multi-head/octopus/tree-style, oil-burning and torchiere-style lamps. The complete policy, including all strictly prohibited items and practices, is outlined in the *Resident Student Handbook*.

Guests

Residents may host visitor(s)/guest(s) without regard to time-of-day or gender provided the host has the permission of their roommate(s) to do so. Access to each residence hall is limited to residents of that specific hall. All others are considered guests. Hosts and guests must complete the *Guest Registration* form. Overnight guests may be hosted by a resident according to registration guidelines. Registration of overnight guests requires the signature of all other residents of the room/suite. The host assumes personal responsibility for the behaviors of the guest(s).

Noise

Quiet hours are established and observed in all residential facilities. Sunday through Thursday nights, quiet hours begin at 10:00 p.m. and end at 10:00 a.m. the following morning. Friday and Saturday nights, quiet hours begin at 12:00 a.m. (midnight) and continue until 10:00 a.m. the following morning. Courtesy hours are observed 24 hours per day. Individual halls and living units may extend quiet hours or establish specific additional quiet hours at their discretion and/or through the *Community Living Agreement*. Quiet hours are observed 24 hours per day during the week before and the week of final examinations.

Pets

The Department of Residence Life and Housing prohibits residents or their guests to bring animals/pets of any kind into the residence halls. The only animals/pets allowed in campus residential facilities are fish in aquariums up to 20 gallons.

Smoking

SUNY Oswego is a tobacco- and smoke-free campus. Smoking of any kind and other uses of tobacco products is strictly prohibited on campus. Use of other smoking apparatus (such as pipes, hookahs, and e-cigarettes, etc.) is also strictly prohibited. For more information, go to:

www.oswego.edu/clean-air

Solicitation

Sales and solicitation by students or private commercial enterprise is prohibited without the prior approval of the Office of Residence Life and Housing and the appropriate student government.

Visitation and Guests

Entry into the living quarters of a residence hall is restricted to visitors or guests of that building's residents. Guests/visitors and hosts must observe

the registration requirements of each residence hall and the resident host assumes full responsibility for their guest's/visitor's behavior. The presence of such visitors and/or guests shall not deny access to or entry into the room or suite by any resident thereof, nor shall visitation cause any undue hardship on any other resident of the room, suite, or building. (No resident is permitted to have a guest(s) or visitor(s) without the advance approval of all roommates.) College policy allows 24-hour visitation but does not permit cohabitation.

FURTHER QUESTIONS

Your Future Housing Assignment

Well, at this point, you may not want to think about where you will be living during your *second* year at SUNY Oswego! So, let us say just this: as a **'RETURNING student' for the fall of 2019**, you will be participating in a Room Selection Process in early spring of 2019. The process will begin with acceptance of the terms of the *Room and Board Agreement*, and payment of a Housing Deposit.

YOU WILL BE RESPONSIBLE for meeting all deadlines and requirements for the returning student housing selection process! The Department of Residence Life and Housing will keep you informed of every step in this process via:

- emails to students' Oswego.edu email accounts.
- postings in residence halls/communities beginning in December.
- *Parents Newsletter* mailed to home address.
- *Student Newsletter* mailed to every student living on campus.
- our web site at www.oswego.edu/reslife
- *The Oswegonian* campus newspaper.
- the campus-wide digital signage network.
- social media such as Facebook and Twitter:
 - www.facebook.com/ResLifeOswego
 - www.twitter.com/OswegoResLife
- staff members within the residence halls (RHD, AHD, RA/RM/GRM).

Residence Hall 2018-2019 Opening & Closing SCHEDULE

FALL Semester 2018

- Fri., August 24th Halls open for new students (9 am)
- Sat., August 25th The Village opens for returning students (9 am)
- Sun., August 26th Halls open for returning students (9 am)
- Mon., August 27th Classes begin
- Wed., November 21st Halls close for Thanksgiving Break (12 noon)
~Village remains open
- Sun., November 25th Halls re-open (12 noon)
- Sat., December 15th Halls close for Winter Recess (10 am)

SPRING Semester 2019

- Thurs., January 24th Halls open for new students (9 am)
- Sun., January 27th Halls open for returning students (9 am)
- Mon., January 28th Classes begin
- Sat., March 16th Halls close for Spring Break (8 am)
~Village remains open
- Sun., March 24th Halls re-open (12 noon)
- Sat., May 18th Halls close for Summer Recess (10 am)

SUNY OSWEGO
residencelife & housing
303 Calkin Hall • Oswego, NY 13126 • p: 315.312.2246 • f: 315.312.6329
www.oswego.edu/reslife

Photo by Rose Throop

END-of-SEMESTER CLOSING (winter and summer recesses): students are expected to leave within 24 hours after their last final examination, but no later than 10:00 a.m. on Saturday, December 15, 2018 (winter recess), and 10:00 a.m. on Saturday, May 18, 2019 (summer recess). Upon request, the Department of Residence Life and Housing may provide limited housing during periods of recess. (Information and fees can be found in the Room and Board Agreement.)

CAMPUS MAP Parking, Handicap, Bus Stops, Construction

Find the campus map online at oswego.edu/about/visit/maps/campus

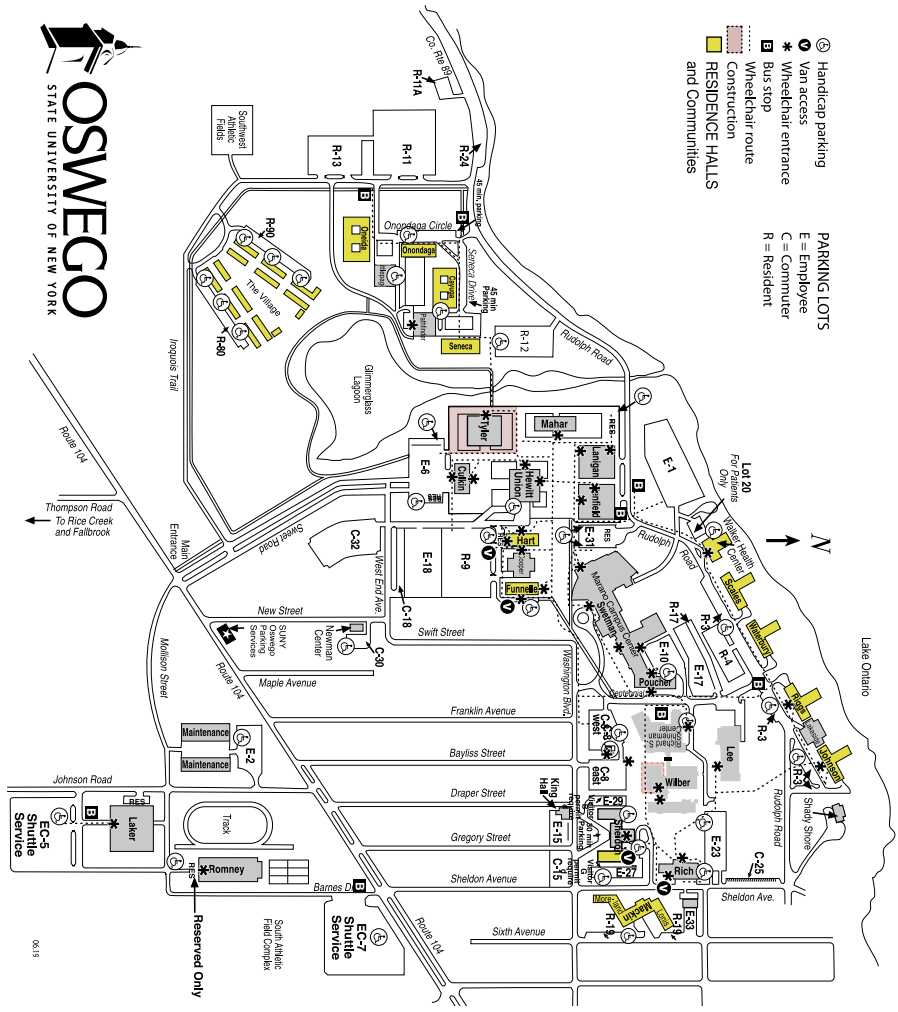

Clip & Save!



SUNY Oswego has sustainability as a core value. This publication was printed regionally using soy-based inks, on 100% post-consumer fiber paper, in an eco-friendly process that recycles virtually all chemical, paper and metal waste.