

Program Study

Intercollegiate Athletics

Legend

- Existing Partition
- New Partition
- New Window
- Existing Door
- New Door

Scope of Work

- Major Renovation: 35,890 GSF
- Minor Renovation: 14,660 GSF
- Provide New Mechanical Equipment: 890 GSF
- Replace Existing Mechanical Equipment: 5,200 GSF
- Install Sprinkler System Only: 8,920 GSF

Laker Hall

Proposed Floor Plans

Basement

Preferred Option
26 January 2017

State University Construction Fund
JMZ Architects and Planners

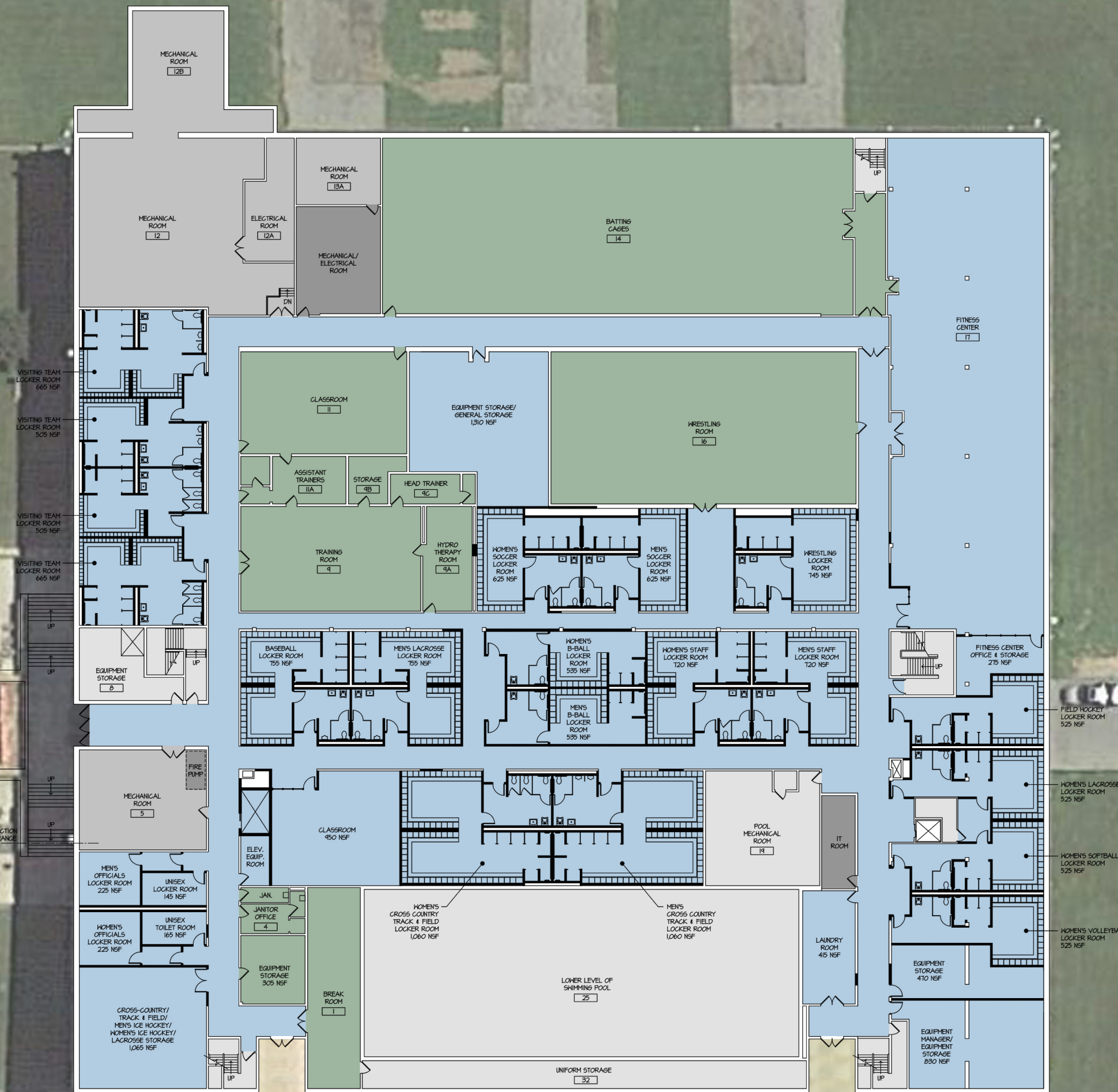

Program Study

Intercollegiate Athletics

Legend

- Existing Partition
- New Partition
- New Window
- Existing Door
- New Door

Scope of Work

- Major Renovation: 16,430 GSF
- Minor Renovation: 41,610 GSF
- Provide New Mechanical Equipment: 0 GSF
- Replace Existing Mechanical Equipment: 250 GSF
- Install Sprinkler System Only: 5,000 GSF



Laker Hall

Proposed Floor Plans

First Floor

Preferred Option
26 January 2017



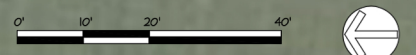

State University Construction Fund
JMZ Architects and Planners



Program Study

Intercollegiate Athletics

Legend

-  Existing Partition
-  New Partition
-  New Window
-  Existing Door
-  New Door

Scope of Work

-  Major Renovation: 18,380 GSF
-  Minor Renovation: 0 GSF
-  Provide New Mechanical Equipment: 0 GSF
-  Replace Existing Mechanical Equipment: 1,480 GSF
-  Install Sprinkler System Only: 1,815 GSF

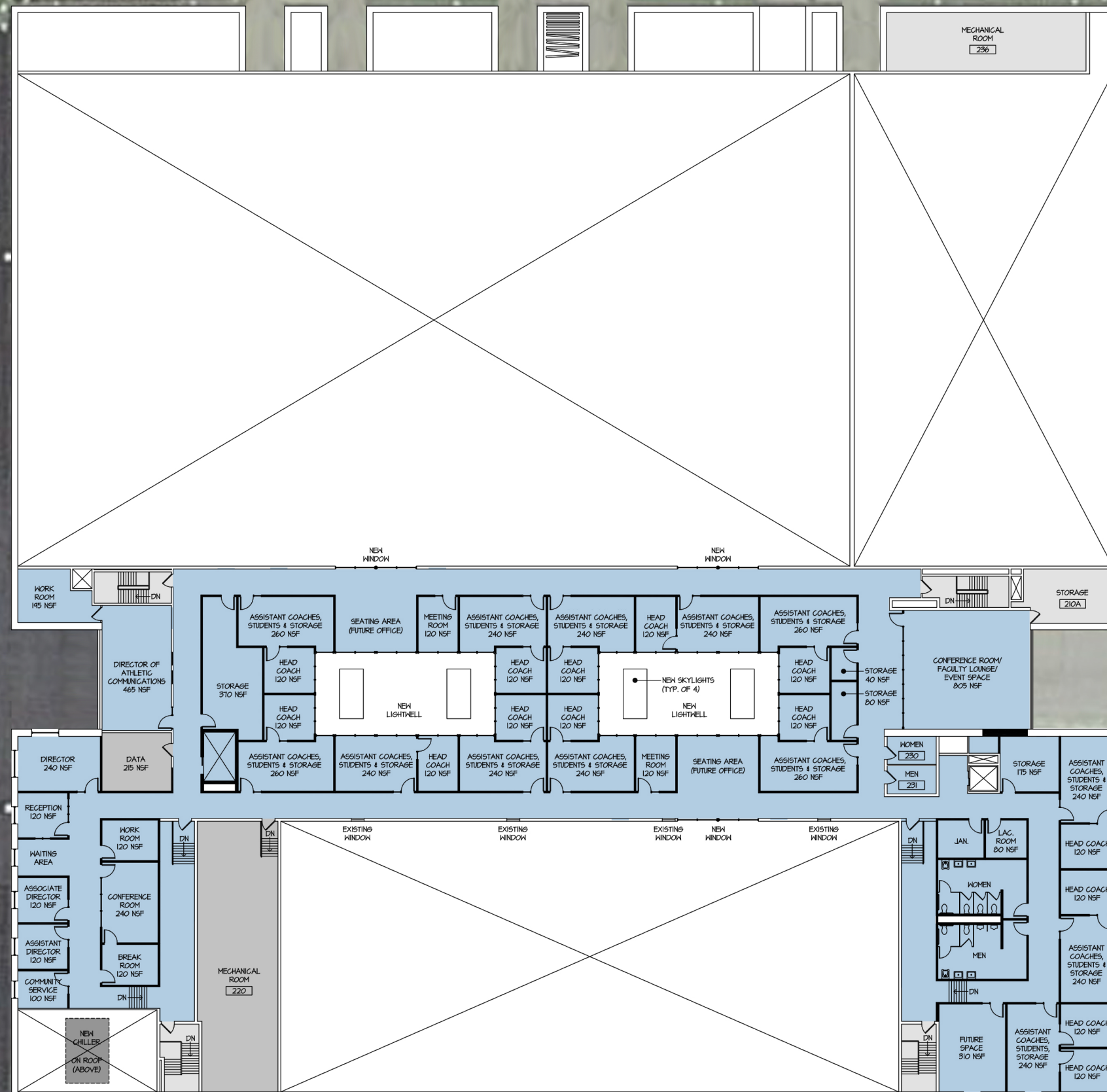

Laker Hall

Proposed Floor Plans

Second Floor

Preferred Option
26 January 2017

State University Construction Fund
JMZ Architects and Planners

