

Notes:



Mission

The Department of Residence Life and Housing actively and continuously strives to enhance and support students' Personal Growth, Intellectual Development, and outlook on Civic Engagement.





WELCOME...

TABLE OF CONTENTS

Director's Welcome	3
Who lives on campus?	4
How are room assignments made?	5
Your Room	6
What telephone service is available?.....	6
Getting connected - what's the connection?.....	6
What television service is available on campus?	6
What should I bring?	7
What else might I want to bring?	8
What if I bring something that's prohibited?	8
How much electric/electronic equipment can one room handle?	8
Should I insure my belongings? Yes, definitely!!	9
How do I create more space in my room?.....	9
What size are the rooms?.....	10
• West Campus Halls	10
Onondaga Hall	10
Cayuga Hall, Oneida Hall, Seneca Hall	11
• Lakeside Halls	12
Johnson Hall, Riggs Hall, Scales Hall, Waterbury Hall.....	12
• Central Campus Halls	12
Hart Hall, Funnelle Hall	12
• East Campus	13
Moreland Hall	
Sheldon Hall 2 person & 3 person rooms	13
• Student Lounges as Bedrooms.....	14
Seneca Hall, Oneida Hall, Cayuga Hall	14
Services	15
Front Desk.....	15

...to life on-campus!

• Mail	14
• Residence Hall Street Addresses	15
• Packages	15
Laundry	15
Storage	15
Early shipment of belongings	17
Recycling	17
Computer labs	17
Security	17
The Department of Residence Life and Housing	18
Residence Hall Staff	18
Departmental Staff.....	18
Fitness Centers.....	18
Policies	19
Alcohol.....	19
Appliances.....	19
Drugs.....	19
Fire Safety.....	19
Overnight Guests	20
Pets.....	20
Smoking	21
Solicitation	21
Visitation and Guests	21
Further questions?	21
Residence Hall Schedule 2011-2012 Academic School Year	22
Fall Semester.....	22
Spring Semester	22

Congratulations!

on your decision to attend Oswego State. The Oswego campus is an excellent environment for learning, and living on campus only enhances the overall learning experience. Students living in residence have the opportunity for informal learning through contact with faculty, staff, and peers. The residential experience provides students with ready access to the intellectual and social events and organizations that are a vital part of the liberal arts college environment.

The experience of living on campus assists students in making a more successful and productive transition to college. Furthermore, living in residence halls helps students attain their academic and personal goals through our Student Learning and Success program. The 'SLAS' program promotes the holistic growth and development of all students through programs that teach acceptance, respect, responsibility, altruism, ethics, and leadership. It also facilitates an environment in which students value diversity of ethnicity, thought, culture, and lifestyle. We expressly encourage student participation in service to the campus and community at large.

We invite you to become an active member of the Oswego State learning community. By living on campus you will share in the excitement of intellectual exploration in and out of the classroom, meaningful and lasting personal growth, and the sharing of ideas, concepts and culture. The relationships you build and the human relations skills you learn will help you socialize and work with others. In your interactions with other students you will have the opportunity to explore your own values.

We are delighted that you will be attending Oswego State and living on campus. Going to college is a huge step in your educational and personal development. We are excited and anxiously await your arrival this fall.

Sincerely,



Richard R. Kolenda
Director of Residence Life and Housing

Who lives on campus?

The College values the educational experiences afforded students by living in College residence halls. These residential experiences create opportunities for informal learning through contact with faculty, staff, and peers. Students in residence benefit from ready access to opportunities for active involvement in the intellectual, cultural, and social events and organizations that are a vital part of campus life. Therefore, all full-time undergraduate students are required to live on campus to the extent that facilities are available and utilized, unless they:

- 1) will continue to reside with their parent(s) or legal guardian(s);
- 2) will continue to reside in their official residence, which is separate from that of their parent(s) or legal guardian(s), and at which they had resided for at least three consecutive months prior to their acceptance of the admissions offer from the College;
- 3) are married; or
- 4) are twenty-one (21) years of age as of September 1 for fall admission or January 1 for spring admission.

Full-time undergraduate students living in College housing who do not fit categories 1 through 4 above may request permission to live off campus for the following academic year by submitting a Petition to Live Off Campus to the Director of Residence Life and Housing or his designee. Generally, requests for permission to live off campus will be granted only for students who first enrolled at the College (as categorized by the Admissions Office) as:

- Fall Semester Freshmen and have lived in College Housing for four (4) consecutive regular semesters (Fall and Spring);
- Spring Semester Freshmen and have lived in College Housing for three (3) consecutive regular semesters (Fall and Spring);
- Fall Semester Transfer Students and have lived in College Housing for two (2) consecutive regular semesters (Fall and Spring);
- Spring Semester Transfer students and have lived in College Housing for one (1) regular semester (Fall and Spring).

How are room assignments made?

By now you have gone online, agreed to the *Room and Board Agreement* and submitted your housing preferences. Housing assignments are made in late June. Once your housing assignment is made, go to **myHousing.oswego.edu** to retrieve your room and roommate information. We encourage you to contact your roommate(s) and begin to get to know one another and start planning what each of you will be bringing for your room.

Although entering students (first year, transfer and readmitted) are given no guarantee of assignment to a specific building or room, every attempt is made to honor students' first or second preferences. Also, the Office of Residence Life and Housing will attempt to honor roommate requests when all students involved have mutually agreed in writing at least sixty (60) days prior to the upcoming semester's first day of classes.

The College will assign roommates for students who do not express roommate preferences. In general, entering students are assigned rooms in accordance with the date on which the College receives their room deposit payment. The College does not discriminate on the basis of race, religion, national origin, or affectional orientation in these assignments.

A note about room assignments:

If you have not received your room assignment by August 1 or have questions, please contact Mary Crow in the Residence Life and Housing Office at (315) 312-2246, Monday through Friday between 8:00 a.m. and 4:00 p.m.



Your Room

Residence hall rooms are typically furnished with a bed, dresser, desk, desk chair, and closet for each resident. Room furnishings also include a floor lamp, three wastebaskets (two for recycling, one for "true trash"), one wall mirror, and blinds. While this setup is standard, by the start of classes each room will begin to develop its own "look." Coordinating the furnishings and arrangements for your room is a good opportunity to become better acquainted with your new roommate. Some things you may want to discuss are:

- sharing belongings
- social and academic expectations and desires
- study and sleep habits
- who is bringing a telephone, TV (cable-ready), electronic equipment
- loft option, etc.

What telephone service is available?

The College no longer provides active dial tone in individual residence hall rooms. For students' convenience, a campus phone is located on each residence hall floor. Students who wish to have dial tone in their room can request service by contacting the Campus Technology Services (CTS) Technology Support Center at help@oswego.edu. Students can also arrange for local and long distance service at this address.

Getting connected - what's the connection?

ResNet is the College's acronym for our *Residential Network*. All campus residence halls are connected to ResNet via Ethernet in each residence hall room. In order to activate this connection, students must first have an activated Instructional Technologies e-mail account. More specific information regarding ResNet can be found at <http://www.oswego.edu/cts/services/resnet/index.html>.

What television service is available on campus?

Residence hall rooms receive access to cable television and each hall has at least one television lounge. A list of stations accessible with a cable-ready television is provided for each student room. Residents can also arrange for additional programming packages

directly with Time Warner. Specific information about these packages will be available in the residence halls.

What should I bring?

Clothing: Unless your parents decide to move and not provide you with a forwarding address, it is not necessary to bring your entire wardrobe when you first move in! Given that dresser and closet space are limited, consider College recesses as opportunities to change your seasonal wardrobes. The first time the halls close during the fall semester is for Thanksgiving break. Typical temperatures in Oswego are:



Septemberwarm (mid 60s)	Februarycoldest (mid 20s)
Octobercool (mid 50s)	Marchcoolest (mid 30s)
Novembercooler (low 40s)	Aprilcool (mid 40s)
Decembercold (high 20s)	Maycool (mid 50s)
Januarycolder (mid 20s)	

Bed and bath linen: You will need to bring your own pillow, pillowcases, sheets, blankets, bedspread, towels and washcloths. Mattress pads are available for your use. All SUNY Oswego regular residence hall mattresses are 80 inches long, 6.5 inches deep and 36 inches wide that require “extra long” twin sheets.

What else might I want to bring?

- Alarm clock
- Area rug
- Camera
- Coffee maker
- Compact refrigerator*
- Computer
- Crates/storage bins
- Dishware/utensils
- Electronic equipment
- Headphones
- Hot pot with automatic shut-off
- Iron
- Laundry supplies
- Memo board (provided in Hart, Johnson and Riggs)
- Power strip (load-limiting)
- Recreational equipment
- Stamps

*Compact refrigerators must not exceed 6 cubic feet and operate on no more than 2.0 amps.

What if I bring something that’s prohibited?

The following items are prohibited. If found in the residence halls, they will be confiscated and disciplinary action will be taken.

- microwave oven
- incense
- cinder blocks
- air conditioners
- other cooking appliances, such as: sandwich makers, grilling machines, hot plates, slow cookers, crock pots
- toaster/toaster oven
- torchiere-style halogen lamps
- candles

Confiscated items **will not** be returned.

How much electric/electronic equipment can one room handle?

The average room has 2 duplex receptacles and 15-amp service. Consider this when determining which electric and/or electronic equipment to bring. Be sure to bring a “load-limiting” power strip. Only fused or breaker-protected extension cords are permitted in residence halls.

Should I insure my belongings? Yes, definitely!!

The College assumes no responsibility for loss, theft or damage to personal property, even if that loss was caused by the failure of a College mechanical system such as a pipe bursting. We strongly encourage you to have insurance coverage before you begin residency. Typically, such coverage may be provided by extension of a homeowner's policy, renter's insurance or insurance specifically for college students. Many vendors offer low cost insurance specifically directed to the college environment. Two such vendors are: CSI (www.CollegeStudentInsurance.com) and Student Personal Property Plan (www.nssi.com).

How do I create more space in my room?

Many students wish to raise the height of their beds to allow for more storage or living space. Our residence hall beds can be positioned at several different heights, creating more storage and/or greater flexibility for room configuration. To request that your bed be positioned at a specific height, visit our website at www.oswego.edu/reslife/forms and click the link for the *Loftable Furniture Layout Options Form* or *Bed Layout Options Form* (Scales and Waterbury Halls only). Fill out and submit the online form no later than July 29, 2011, to be certain your room will be ready for you when you arrive. Late requests will be accepted but cannot be guaranteed.



What size are the rooms?

Although the actual dimensions of rooms vary from building to building, the average square footage is 185. In order to plan for the set up of your room, we have provided diagrams and measurements of each residence hall below.

• *West Campus Halls*

Onondaga Hall*

600 Residents

10 Floors - Suites (Upper-class students only)

Ceiling Height - 8'

Window Frame: 51.25" x 63.75" - 1st floor

Window Frame: 51" x 58" - 2nd through 10th floors

Closets - width = 41", depth = 21"

*Onondaga is the only residence hall on campus that has suites. There are primarily 3-room suites and a few 2-room suites in the building. Suites are unique in that they have a private bathroom and common living area that only the suitemates share.

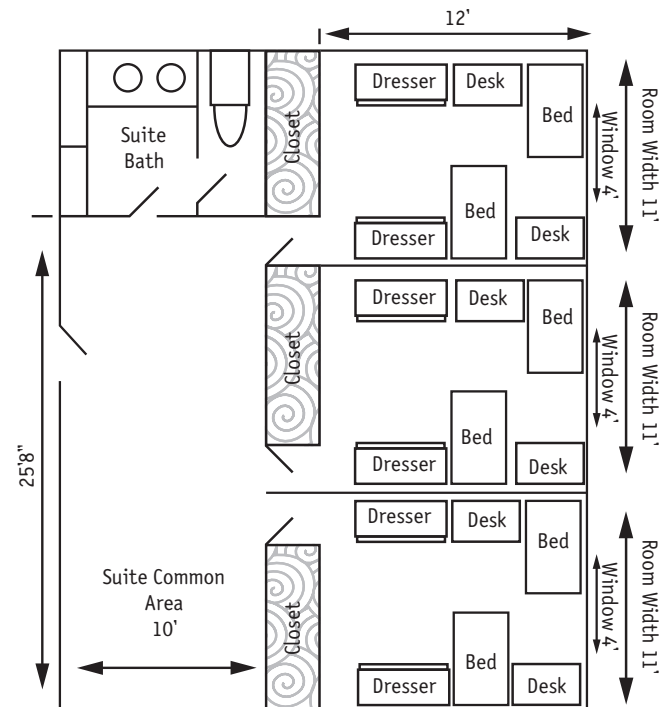

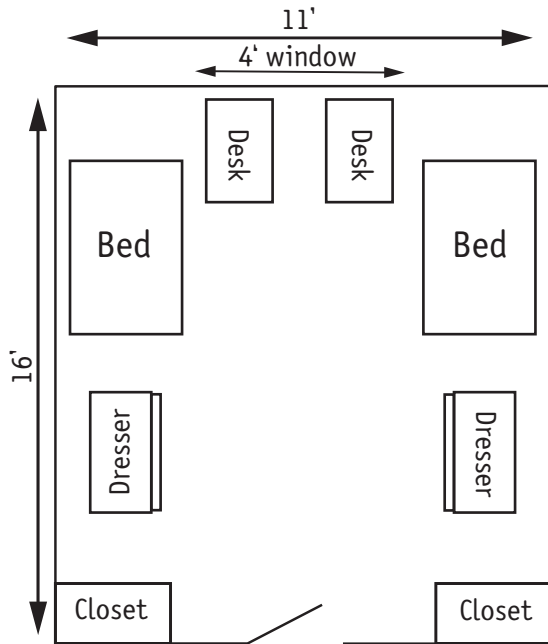

• *West Campus Halls*

Cayuga Hall*
 400 Residents
 4 Floors
 Ceiling Height - 8'
 Window Height - 64"
 Closets - width = 43"
 depth = 23.5"

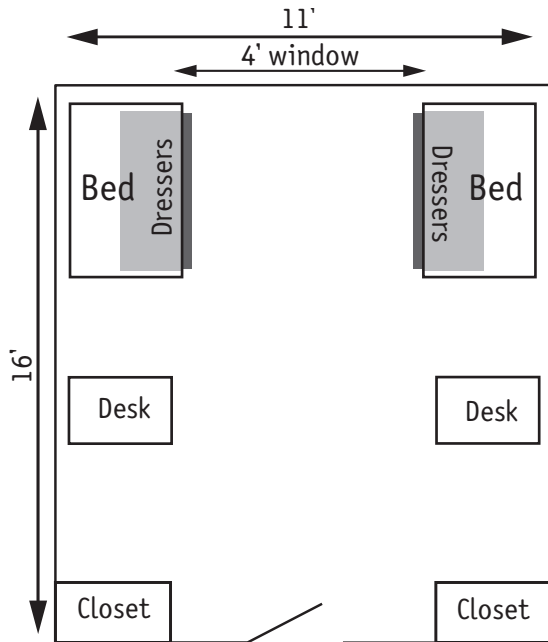

Oneida Hall*
 400 Residents
 4 Floors
 Ceiling Height - 8'
 Window Height - 56"

Seneca Hall*
 600 Residents
 10 Floors
 Ceiling Height - 8'
 Window Height - 64"
 Closets - width = 43"
 depth = 23.5"

*For lounges as bedrooms, see page 14

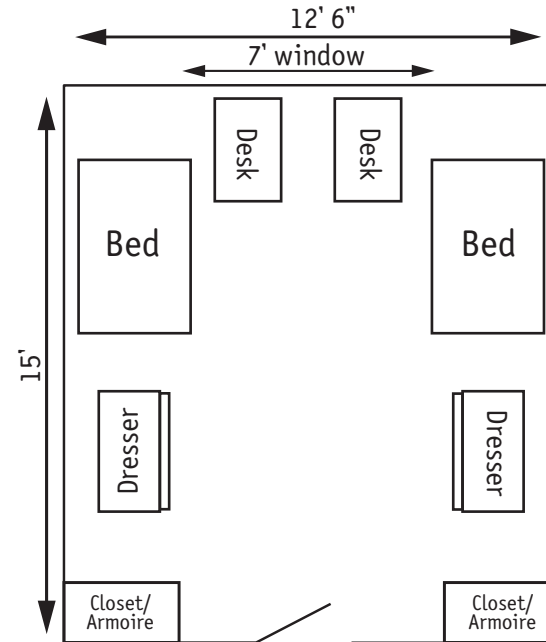

• *Lakeside Halls*

Johnson Hall
Riggs Hall
Scales Hall
Waterbury Hall
 200 Residents
 Ceiling Height - 8'
 Window Height - 53.5"

Scales and Waterbury:
 Closets - width = 41"
 depth = 29"

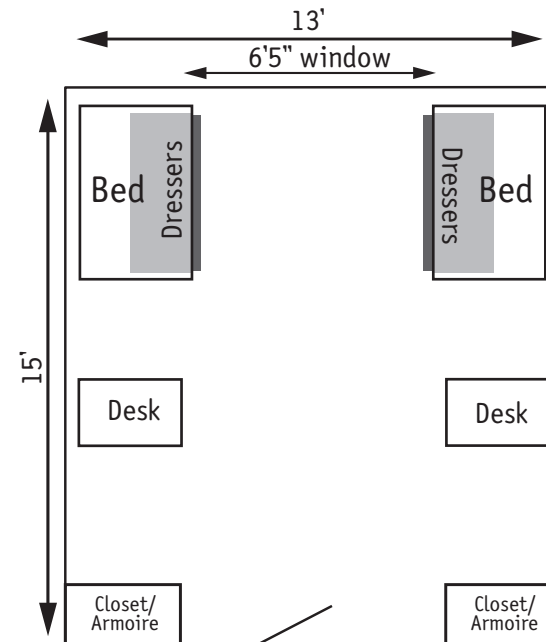

• *Central Campus Halls*

Hart Hall
 336 Residents
 9 Floors
 Ceiling Height - 8'
 Window Height - 52.5"

Funnelle Hall
 400 Residents
 9 Floors
 Ceiling Height - 8'
 Window Height - 53"
 Closets - width = 52"
 depth = 26"

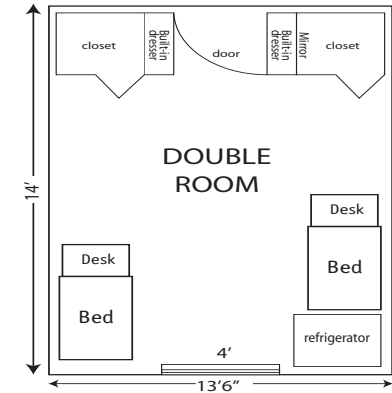

• **East Campus**

Moreland Hall

145 Residents
Ceiling Height - 8'
Window Height - 53.5"

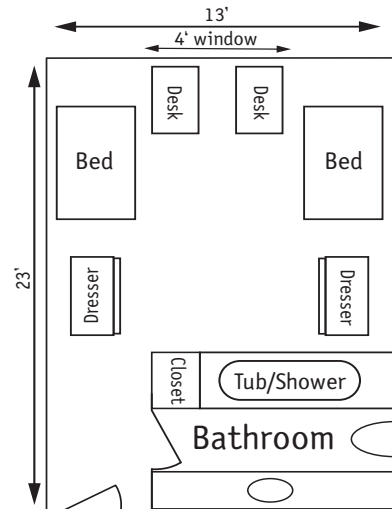

Sheldon Hall

70 Residents
2nd and 3rd Floors,
east wing of the historic
Oswego Normal School
building.

Typical Double Room
Ceiling Height - 12'
Window: drapes provided

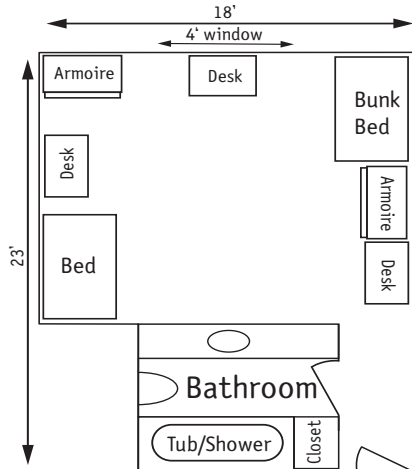

Typical Triple Room
Ceiling Height - 12'
Window: drapes provided

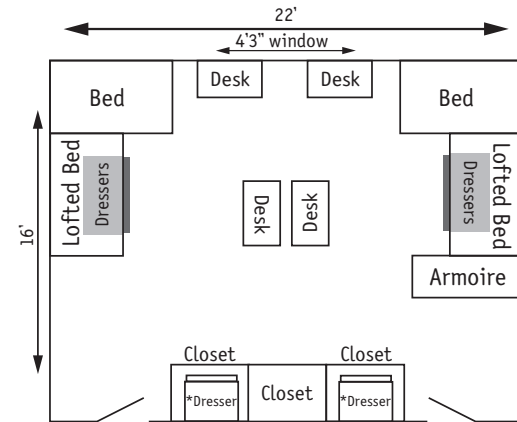

• **Student Lounges as Bedrooms**

Seneca Hall Lounge

3-4 Residents
Ceiling Height - 8'
Window Height - 58.5"

*Dresser= Two
dressers stacked one
on top of the other.

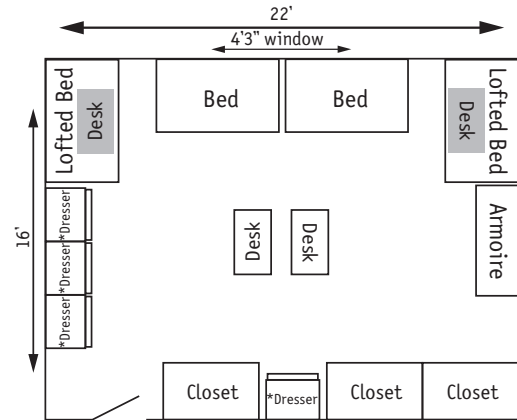

Oneida Hall Lounge

3-4 Residents
Ceiling Height - 8'
Window Height - 56"

*Dresser= Two
dressers stacked one
on top of the other.

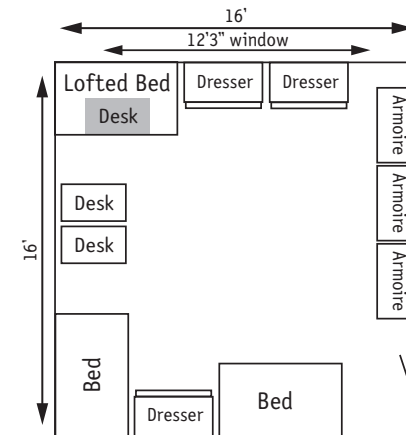

Cayuga Hall Lounge

2-3 Residents
Ceiling Height - 8'
Window Height - 42.5"

Services

Front Desk

Each residence hall has a front desk located in the main lobby. The desk is open from 10:00 a.m. to 3:00 a.m. seven days a week during the Fall and Spring academic semesters. Students are employed as Desk Attendants to provide information and services, such as the following: processing mail and packages; providing residents with temporary keys if they are locked out of their rooms; loan of board games, sports equipment (i.e., pool cues, ping pong paddles), cooking supplies, vacuum cleaners, snow shovels, brooms, and dustpans.

All halls have DVD players and DVDs available for loan; some halls also have current video game systems that are loaned out at the front desk. Each hall also has a microwave oven for resident use.

- Mail

Each resident is assigned a mailbox located near the front desk of each residence hall. Mail is received and sorted at the front desk Monday through Saturday. Mail delivery will work most efficiently if mail is addressed as indicated below.

In most halls, each student has his or her own mailbox; in these halls (Cayuga, Hart, Johnson, Lonis, Riggs, Scales, Sheldon, Waterbury and The Village), the mailbox number is different from the room number. To send mail to students in these halls, be sure to include the student's mailbox number in the address.



Student Name (last name is very important!)
_____ Hall, Mail Box # _____ (Room)*
Street Address (see next page)
Oswego, NY 13126

*In Funnelle, Oneida, Onondaga and Seneca Halls, roommates share a mailbox; in these halls, the mailbox numbers are the

same as the room numbers. To send mail to students in these halls, please include the student's room number in the address.

Please note that the College cannot be responsible for cash or valuables sent through the mail.

- **Residence Hall Street Addresses**

The current 911 street addresses for each of the Residence Halls on campus is as follows:

- Cayuga Hall20 Cayuga Circle
- Funnelle Hall25 Union Road
- Hart Hall15 Union Road
- Johnson Hall20 Rudolph Road
- Mackin Complex
(Lonis Hall and Moreland Hall) ..53 Sheldon Avenue
- Oneida Hall10 Onondaga Circle
- Onondaga Hall20 Onondaga Circle
- Riggs Hall28 Rudolph Road
- Scales Hall34 Rudolph Road
- Seneca Hall47 Cayuga Circle
- Sheldon Hall72 Sheldon Avenue
- Waterbury Hall30 Rudolph Road

- **Packages**

Packages shipped/mailed to residents are received at the front desk. If the desk receives a package for you, you will receive a "package slip" in your mailbox and must go to the front desk to pick it up.

Laundry

Each residence hall is equipped with laundry facilities. Cost for use is pre-paid as a fee on the student's college bill.

Storage

Luggage rooms are available in most residence halls to provide limited storage space for small items such as empty trunks and suitcases.* Fire regulations prohibit storage of cardboard boxes

in these areas. In determining how much to bring to school, bear in mind that the College will not store student belongings over the summer; you will need to take all your belongings with you in May. Plan to put any items of value in your room where they will be most secure.

* *There are no luggage rooms in Johnson and Riggs Halls.*

Early shipment of belongings

We do not accept shipments prior to our announced arrival date for residents. If you must make shipments to campus, please plan accordingly and include your full College address.

Recycling

Oswego State participates in the mandatory Oswego County recycling program. All students are required to routinely bring all recyclables and trash to a Recycling Room located in the basement of each residence hall.

Computer Labs

Oneida and Scales Halls also have computer labs that are open to all students. These in-hall facilities allow ready access to computers and the campus network. The labs are open daily and are staffed by student “Computer Technicians.”

Security

In order to ensure reasonable security, there are policies and procedures in place to govern access to the buildings, locking and unlocking of building doors, and monitoring of visitors and guests. The specifics of these procedures (and all other policies and procedures) are listed in the *Resident Student Handbook*, available on-line.

The Department of Residence Life and Housing

The Residence Life and Housing program at Oswego strives to provide students with a safe, well-maintained, and attractive living environment supportive of the educational mission of the College. Students living in residence have the opportunity for informal learning through contact with faculty, staff, and peers. The residential experience provides students with ready access to the intellectual and social events and organizations that are a vital part of the liberal arts college environment.

Residence Hall Staff

Each residence hall is staffed by a team of professional, student and custodial employees. Together with the residents and other College personnel, they work to provide the positive living experience at the core of our department’s mission.

Each hall has a Residence Hall Director, a full-time professional who lives in the residence hall. Buildings of 400 or more residents also have Assistant Hall Directors (graduate students who also live in the hall).

Each hall also has Resident Student Staff (RSS) who are RAs (Resident Assistants), RMs (Resident Mentors) or GRMs (Graduate Resident Mentors). These undergraduate and graduate students are employed and trained by the Department of Residence Life & Housing to provide a quality living and learning experience for residents. They live directly on the resident floors and serve as role models, helpers, counselors, administrators, mentors and friends.

Furthermore, RSS enforce College policies to ensure that the health, safety and rights of all individuals are maintained. In addition, RMs (Johnson Hall) and GRMs (Hart Hall) have academic duties related to the special programs in their respective buildings. The front desks, recycling rooms and computer labs (if

applicable) are staffed by student employees. The Desk Attendants, Recycling Technicians and Computer Lab Technicians play a very important role in the functioning of the hall. Many halls will be hiring to fill vacancies in these positions in the fall.

Our residence halls are also staffed by custodians seven days per week throughout the Fall and Spring semesters. Together with Facilities Services, they ensure the cleaning and maintenance of our halls in compliance with a schedule of standards and routines. Copies of these standards are available at each residence hall front desk and the Residence Life and Housing Office, 303 Culkin Hall.

Departmental Staff

The staff who work directly in the residence halls are supported and supervised by the Department's Management Team, which includes the Director of Residence Life and Housing, three Associate Directors, and four Community Development Specialists. All of these professionals have served as educators in college environments for many years. They are committed to student growth and development as well as the training and enhancement of our professional and paraprofessional residence hall staff.

Fitness Centers

Residence Life and Housing also operates two on-campus fitness centers. Cooper Fitness Center is located between Hart and Funnelle Halls, and Glimmerglass Fitness Center is located between Oneida and Onondaga Halls. Under the direction of a full-time manager and 2 assistant managers, the centers are staffed by well-trained undergraduate students. In addition to use of the facilities, members benefit from the training and expertise of the Fitness Center staff, who are available to assist members with varying levels of experience in fitness and training. Both Fitness Centers are equipped with free weights, Cybex circuits, cardiovascular equipment (including stairmasters, treadmills, etc.), and offer a wide variety of group exercise classes. Personal Training and Diet Analysis services are also available and



Fitness Center staff plan and facilitate several special events and presentations throughout the academic year; two examples are the Bench Press Competitions and a Beach Volleyball Tournament.

Non-resident membership costs vary according to the length of time a student lived on campus. The rates for resident students for the 2010-2011 academic year are:

per semester	\$60
per academic year	\$80

Policies

Alcohol

The College permits individual consumption and possession of alcoholic beverages by individuals who have attained 21 years of age and prohibits consumption and possession by persons under 21. Open containers of alcohol are prohibited in public areas of the residence halls. Group consumption of alcohol in residence halls may occur only at registered events as explained in campus guidelines. Refer to the alcohol and drug section of the *Student Handbook* for the complete policy description.

Appliances

All electrical appliances must be UL approved and must be in good working order. Prohibited appliances are included in the list of prohibited items earlier in this publication (see page 8). Any prohibited appliance found in the residence hall will be confiscated by Residence Life and Housing staff and will not be returned to its owner.

Drugs

The use, possession, distribution or manufacture of controlled substances is prohibited on College premises. The possession and/or use of small amounts of marijuana in one's room is a violation of New York State law, and any consumption of marijuana

in a public area is a criminal offense. Drugs or drug-related paraphernalia can be confiscated and used as evidence.

Fire Safety

All individuals are expected to evacuate the building upon the activation of the fire alarm system. Failure to evacuate a building during a fire alarm and the theft or improper use of fire fighting, detection, and/or alarm equipment is prohibited and may result in arrest and/or College disciplinary action. Included in this prohibition are torchiere-style halogen lamps. Furniture, decorations, and other items that increase the flammability of the resident rooms or public areas may be prohibited at the discretion of the residence hall staff. Possession and/or ignition of combustible materials for the purpose of cooking, heating, lighting or display (including but not limited to candles, incense, and oil-burning lamps) is prohibited. **Anything that is confiscated will not be returned.** Setting fire is prohibited with the exception of designated fireplaces.

Guests

Residents may host visitor guest(s) without regard to time-of-day or gender provided the host has the permission of their roommate(s) to do so. The residence hall may require registration of visitor guests at certain times of the day; otherwise no registration is required. Overnight guests may be hosted by a resident according to registration guidelines. Registration of overnight guests requires the signature of all other residents of the room/suite. The host assumes personal responsibility for the behaviors of the guest(s).

Pets

In order to allow residents the option of having a pet in their residence hall room, the department has developed a *Pet Policy*. Residents who register and comply with all of the provisions of the policy may possess one of the following:

Hamsters, gerbils, domestically bred rats, parakeet-sized birds, fish in aquariums up to 20 gallons, small lobsters 6 inches and smaller, turtles 9

inches and smaller, chameleons and geckos of a maximum 7 inches in length (including its tail) or smaller, hermit crabs and soapdish crabs in aquariums up to 20 gallons, and guinea pigs.

The number of pets in any one area can affect the quality of life for all; therefore, residents may register a maximum of two same-gender of one type of pet.

The department requires roommate agreement for all pets; therefore, residents new to Oswego are given a chance to become acquainted with each other before agreeing to having a pet in the room and may not obtain permission sooner than **September 15** (fall semester) or **February 10** (spring semester). Registration forms may be obtained from your Residence Hall Director.

Smoking

Smoking is prohibited inside, and outside within 20 feet of, all residence halls.

Solicitation

Sales and solicitation by students or private commercial enterprise is prohibited without the prior approval of the Office of Residence Life and Housing and the appropriate student government.

Visitation and Guests

Entry into the living quarters of a residence hall is restricted to visitors or guests of that building's residents. Guests/visitors and hosts must observe the registration requirements of each residence hall and the resident host assumes full responsibility for their guest's/visitor's behavior. The presence of such visitors and/or guests shall not deny access to or entry into the room or suite by any resident thereof, nor shall visitation cause any undue hardship on any other resident of the room, suite, or building. (No resident is permitted to have a guest(s) or visitor(s) without the advance approval of all roommates.) College policy allows 24-hour visitation but does not permit cohabitation. Each residence hall government has the option to further restrict such visitation according to the wishes of the residents.

FURTHER QUESTIONS?

If you have any questions that are not answered in this booklet, feel free to call Residence Life and Housing at (315) 312-2246, Monday through Friday, 8:00 am - 4:00 pm or check our website:

<http://www.oswego.edu/reslife>

See you soon!



Residence Hall Schedule

2011–2012

Academic School Year

Fall Semester 2011

- Friday, August 26thHalls open for new students (9 am)
- Saturday, August 27thThe Village Townhouses open
- Sunday, August 28thHalls open for returning students (9 am)
- Monday, August 29thClasses begin
- Wednesday, November 23rd . . .Halls close for Thanksgiving Recess (8 am)
The Village will remain open.
- Sunday, November 27thHalls re-open (12 Noon)
- Saturday, December 17thHalls close for Winter Recess (10 am)

Spring Semester 2012

- Thursday, January 19thHalls open for new students (9 am)
- Sunday, January 22ndHalls open for returning students (9 am)
- Monday, January 23rdClasses begin
- Saturday, March 10thHalls close for Spring Break (8 am)
The Village will remain open.
- Sunday, March 18thHalls re-open (12 Noon)
- Saturday, May 12thAll on-campus housing facilities
close for Summer Recess (10 am)

For end-of-semester closing (winter and summer recesses), students are expected to leave within 24 hours after their last final examination, but no later than 8:00 a.m. on Saturday, December 17, 2011 (for winter recess), and Saturday, May 12, 2012 (for summer recess). Upon request, the Department of Residence Life and Housing can provide limited housing during periods of recess.